



SWISSPEARL ARCHITECTURE 6

International Edition – High Profile Buildings

SWISSPEARL®

Terraços de Cascais, Cascais, Portugal

HIGH-END SEASIDE HOUSING

‘Moderate luxury through efficiency’ seems to be the slogan behind this high performance/low maintenance apartment development on the Portuguese Atlantic coast. Embedded in the trendy exclusivity of this new age/old-feel fishermen’s village thirty motorway minutes or so west of Lisbon, a group of ten spacious apartments has been inserted as a line of four stepped blocks into the steep and narrow lot of a former vineyard.

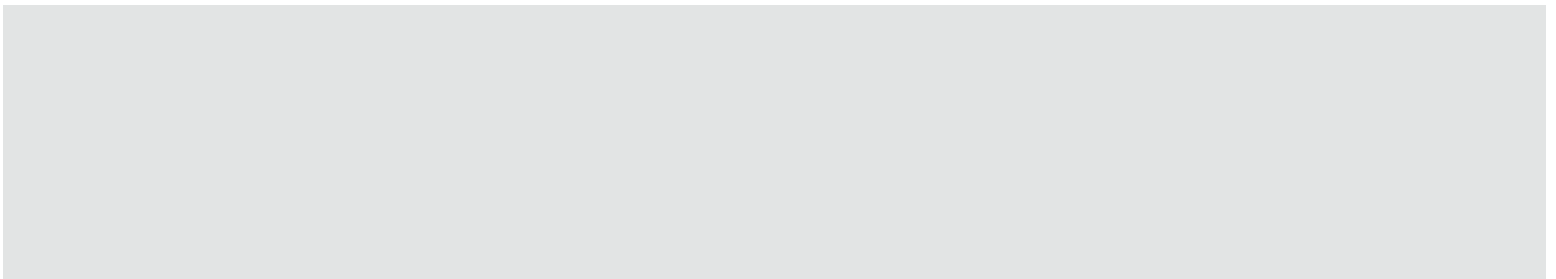
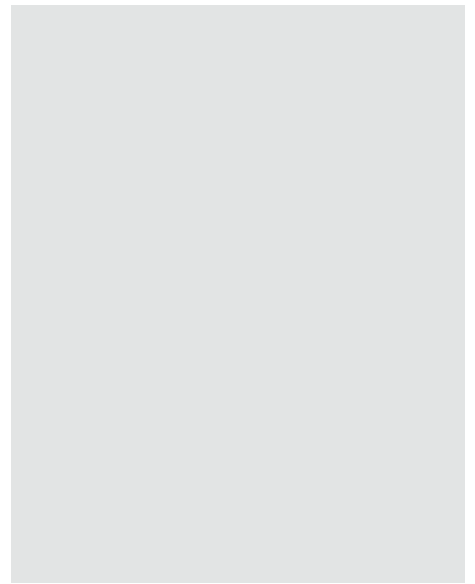



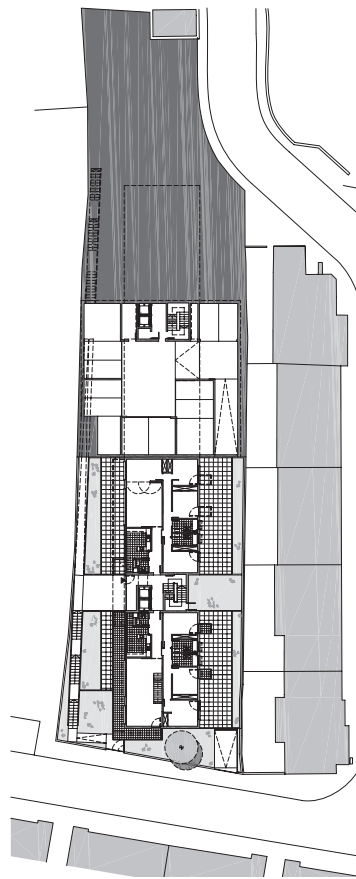

Second floor 1:1000

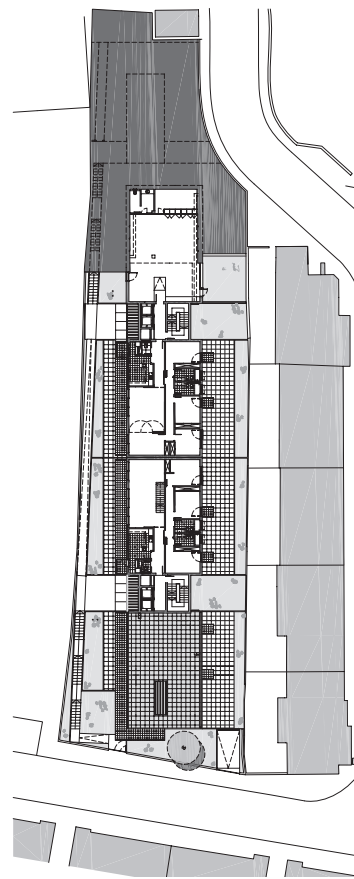

Fourth floor

**“THE STRUCTURAL SYSTEM, AS WELL AS THE MATERIALS USED, WAS CONCEIVED FROM THE OUTSIDE, SURROUNDING THE WALLS AND STRUCTURE AND PROVIDING THE INTERIOR WITH THE IDEAL THERMAL CONDITIONS.”
HUMBERTO CONDE**

The proximity to the Atlantic Ocean with its diverse range of leisure activities, plus the attractiveness of the centre of Cascais with its many top ranking shops and restaurants distinguishes the ‘Terrazos de Cascais’ as a high-end resort development where residents might spend weekends or parts of the year, or alternatively commute to their work places on a daily basis. This flexibility of use is justifiably being employed as a practical marketing argument since it offers multiple possibilities, thus ensuring the sustainable attitude of a medium to long-term turnaround of the development. Swisspearl panels therefore are the consequential choice of façade material. Cultural sustainability is maintained by intelligent, ‘landscape-wise’ terracing of the building formation and its scaled access facilities, and it is supported by the choice of colour and finishing of materials that fit in with the environment rather than

dominating it. The morphology of the building is derived almost exclusively from the specific topography of the site. “Different platforms at different heights, slightly adjusted to the terrain, allow for innumerable perspectives over the land and sea. The structural system, as well as the materials used, was conceived from the outside, surrounding the walls and structure and providing the interior with the ideal thermal conditions”, says architect Humberto Conde.

The finishing material assumes a particular dominance with the ventilated Swisspearl façades in ‘Sapphire’ grey/blue panels that enter into dialogue with the colour of the sky. The ventilated façades ensure efficient insulation, prevent thermal bridges, and work as a durable protective exterior skin for the structural walls and internal elements and achieving considerable energy saving throughout the



Swisspearl panels 'Sapphire' enter into dialogue with the colour of the sky.

seasons. The use of glass balustrade panels for the balconies provides an elegant, homogenous consistency of material and colour. Grey aluminium shading devices go hand in hand with the high-tech grey Swisspearl panels; the louvre movements add a certain amount of individuality to the building composition since each inhabitant adjusts his or her own daylight control within the apartment.

All in all a convincing fusion of commerce and conscious contemporary development, the architectural project by Humberto Conde Architects has been awarded an Oscar by the magazine 'Revista Imobiliária' for the best real estate project in the housing category. *Thyone Dyon*

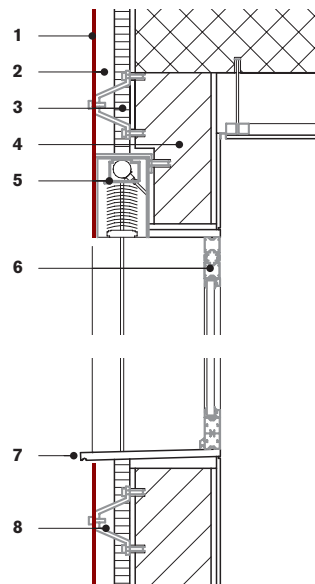

- 1 Swisspearl® cement composite panel
- 2 Ventilation 60 mm
- 3 Thermal insulation 40 mm
- 4 Brick wall
- 5 Exterior sun screen, wide aluminium jalousie
- 6 Aluminium window, anodised surface, natural colour
- 7 Natural stone 25 mm
- 8 Aluminium profile

Vertical Section 1:20



Sustainability aspects:
long-lasting Swisspearl
façade materials
combined with 'land-
scape-wise' building
morphology.



Location Rua Ribeira das Vinhas, Cascais, Portugal
Client, developer, and general contractor Cereja & Associa-
dos, Carcavelos
Architects HRA Humberto Conde Arquitectos, Lisbon
Building period 2006
Façade construction ArquiWall, Palmela
Façade material SWISSPEARL® CARAT, Sapphire 7061